

FILED FOR RECORD: 3-20 19 84 at 10:25 o'clock A M
 DULY RECORDED: 3-22 19 84 at 9:00 o'clock A M
 INSTRUMENT NO. _____ GRACE BOSTICK, TYLER CO. CLK.
 BY: Jean Phillips Deputy
 JEAN PHILLIPS

TYLER COUNTY COMMISSIONER'S COURT
 REGULAR MEETING
 MARCH 12, 1984---10:00 A. M.

VOL 009 PAGE 34

The Regular Meeting of the Commissioner's Court met on Monday, March 12, 1984, at 10:00 A. M. All members being present. The meeting was opened with prayer by Commissioner James R. Jordan.

A motion was made by Commissioner Lowe and seconded by Commissioner Riley to table until Friday, March 16, 1984, at 10:00 A. M., any decision to be made concerning the bids received on new dump trucks for Pcts. I, II and IV, in order that further study of the bids can be made. All voted yes and none no. Bids received are as listed:

- 1 Allison Chevrolet Co., Colmesneil, Texas
- A & M Motor Co., Inc., Woodville, Texas
- Knapp Ford Sales, Inc., Woodville, Texas

A motion was made by Commissioner Lowe and seconded by Commissioner Mahan to approve the monthly report of the County Treasurer, as submitted by County Treasurer Austin Fuller, All voted yes and none no. See Attached.

A motion was made by Commissioner Mahan and seconded by Commissioner Lowe to table until Friday, March 16, 1984, at 10:00 A. M., any decision to be made concerning the monthly report of the County Extension Service. All voted yes and none no.

A motion was made by Commissioner Lowe and seconded by Commissioner Jordan to approve the Contract with Kirby Forest Industries, granting permission to Precinct II to remove iron ore gravel from Kirby property in the G. W. Roper Survey, Abstract 757, Tyler County, to be used on roads located in Precinct II. All voted yes and none no. See Attached.

A motion was made by Commissioner Riley and seconded by Commissioner Lowe to renew the yearly lease with Chem-Air for the Tyler County Airport, pending minor changes, to be approved by County Attorney Pat Hardy; also, with approval of Chem-Air. All voted yes and none no.

County Treasurer Austin Fuller met with Commissioner's Court, to request permission to hire another full time secretary, explaining that his office was understaffed and overworked at this time. After some discussion concerning the matter presented, a motion was made by Commissioner Mahan and seconded by Commissioner Lowe to allow Mr. Fuller to hire another person as relief personel for vacation purposes, two (2) weeks only. All voted yes and none no.

A motion was made by Commissioner Mahan and seconded by Commissioner Lowe to table any decision to be made concerning the County's Postage meter, now located in the County Treasurer's office, until a later date. All voted yes and none no.

There being no further business, the meeting adjourned.

SIGNED: Allen Sturrock Allen Sturrock, County Judge

Maxie Riley Maxie Riley, Comm. Pct. #1

H. K. Lowe H. K. Lowe, Comm. Pct. #2

Jerry Mahan Jerry Mahan, Comm. Pct. #3

James R. Jordan James R. Jordan, Comm. Pct. #4

ATTEST: Grace Bostick Grace Bostick, County Clerk

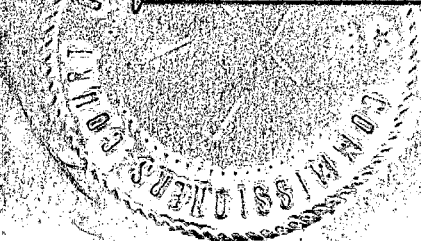

NOTICE OF TIME AND PLACE OF MEETING
COMMISSIONER'S COURT
TYLER COUNTY, TEXAS

THIS NOTICE POSTED IN ACCORDANCE WITH V. A. T. S. _ Art. 6252-17

Notice is hereby given that Commissioners Court will hold it's regular meeting on Monday MARCH 12, 1984 at 10:00 A. M. in the Commissioners Courtroom, First Floor, Tyler County Courthouse.

A G E N D A
- - - - -

1. APPROVE COUNTY TREASURERS MONTHLY REPORT.
2. APPROVE COUNTY EXTENSION MONTHLY REPORT.
3. APPROVE CONTRACT WITH KIRBY FOREST INDUSTRIES.
4. RENEWAL OF CHEM-AIR LEASE AT AIRPORT.
5. AUSTIN FULLER.
6. POSTAGE MACHINE.
7. OPEN BIDS ON THREE DUMP TRUCKS FOR PCTS. I, II AND IV.

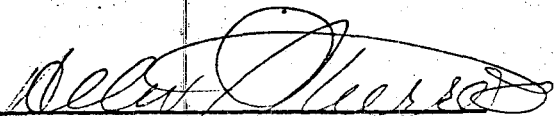
Allen Sturrock, County Judge
Tyler County, Texas

NO. _____ TIME: 10:00 AM
PM

MAR 9 1984

GRACE BOSTICK, COUNTY CLERK
TYLER COUNTY, TEXAS

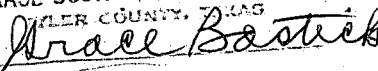
BY: 

BALANCES, RECEIPTS AND DISBURSEMENTS

All Funds

VOL 009 PAGE 35

Month Of Feb. 1984

FUND	Cash On Hand	Receipts Present Month	Transfers In (Out)	Disbursements	Cash On Hand	Certificates of Deposit	Available Resources
General	(385,849.55)	587,141.47	1,717.40	656,376.38	(454,367.15)	1,116,843.77	662,476.61
Solid Waste							
Tyler County Auto Report	(4,131.65)	54,544.70	(19,590.21)	28,337.59	2,485.25	23,832.73	26,317.96
Library	13,923.35	135.00		22.91	14,035.44		14,035.44
Capital Improvements	164,748.80			2,435.80	162,313.00		162,313.00
R & B # 1	37,698.46	293.48	74,067.67	83,997.30	30,062.31	91,977.71	120,040.02
R & B # 2	62,212.57	222.37	62,618.42	56,948.84	58,104.52	77,969.29	136,073.81
R & B # 3	(1,677.09)	1,791.01	87,482.33	100,459.84	(12,863.59)	108,928.57	96,064.98
R & B # 4	70,593.00	268.32	79,267.34	84,788.63	65,340.03	98,699.69	164,039.72
County Attorney Check Fees	18.63	405.00		338.50	85.13		85.13
District Attorney Check Fees	970.04			100.92	869.12		869.12
General R & B # 2		285,681.95	(285,681.95)				
Adult Probation	39,097.62	4,835.00	119.00	6,222.74	37,828.88		37,828.88
Juvenile Probation	6,397.48	3,800.16		2,424.23	7,773.41		7,773.41
County Wide ROW	15,775.51	37.72			15,814.23		15,814.23
State Cost #1	5,876.60	1,915.00			7,791.60		7,791.60
State Cost #2	459.50	323.00			782.50		782.50
State Cost #3		775.00			775.00		775.00
State CVC	166.50	560.00			726.50		726.50
Totals	25,280.67	942,729.18	.00	1,032,453.68	(64,443.83)	1,518,251.76	1,453,807.93

FUND	Cash on Hand	CD	Deposit	Disbursement	Cash on Hand	Available Resources
Federal Revenue Sharing Acct. # 003-420						
Federal Revenue Sharing Totals	65,994.73		40,545.87	7,644.01	59,350.72	99,897.59
Bank Statement Balance	59,430.64					
Less Outstanding Checks				79.92		
Total Cash In Bank					59,350.72	

TYLER COUNTY PAYROLL:

General	56,050.06
R & B # 1	8,269.00
R & B # 2	6,621.00
R & B # 3	11,140.20
R & B # 4	9,045.00
Rev. Shar.	2,001.00
C A C F	300.00
Adult Prob.	4,640.16
Juvenile Prob.	1,950.00
TOTAL	100,016.42

INDEBTEDNESS:

R & B # 1-Mustang Tractor Grader	56,660.80
John Deere Tractor # 4071	5,000.00
Crawler # 4040	7,222.75
R & B # 3-Backhoe	9,997.50
Motor Grader	27,551.00
Mack Truck # 4062	32,846.25
R & B # 4-Motor Grader	28,260.00
Total Indebtedness	167,538.30

Bank Statement Balance	52,221.70
Less Outstanding Ck	50,145.56
	2,076.14
Deposits	4,891.58
	5,749.85
	12,717.57
Retirement	-12,716.70
	.87

SOCIAL SECURITY FUND 935.63

Austin Fuller, County Treasurer

WITNESS OUR HANDS, officially, this 12 day of March A.D., 1984

Commissioner Pct 1

Commissioner Pct 2

County Judge

Commissioner Pct 3

Commissioner Pct 4

SUBSCRIBED AND SWORN TO BEFORE ME This _____ day of _____ 1984.

Tyler County Clerk, Grace Bostick

By:

Deputy

COUNTY AUDITORS MONTHLY REPORT
STATEMENT OF REVENUE, EXPENDITURES & CASH BALANCES
FOR THE MONTH OF FEBRUARY 1983

VOL 009 PAGE 36

FUND	CASH BALANCE 2-01-84	TOTAL REVENUE	TRANSFERS		PERSONAL EXPENDITURES	OPERATING EXPENDITURES	INDEBTED- NESS	CASH BALANCE 2-29-84
			IN	OUT				
OPERATING FUNDS:								
General Fund	\$178,150.35	\$587,141.47	\$ 2,035.25	\$ 317.85	\$ 69,922.29	\$ 34,330.59	\$ -0-	\$ 662,756.34
Road & Bridge I	63,069.50	293.48	74,067.67	100.00	10,093.31	7,197.32	-0-	120,040.02
Road & Bridge II	83,719.55	222.37	62,618.42	-0-	8,327.71	2,158.82	-0-	136,073.81
Road & Bridge III	28,369.66	1,791.01	87,482.33	-0-	13,813.04	7,764.98	-0-	96,064.98
Road & Bridge IV	97,818.23	268.32	79,267.34	-0-	11,594.45	1,719.72	-0-	164,039.72
General Road & Bridge	-0-	285,681.95	17,554.96	303,236.91	-0-	-0-	-0-	-0-
SPECIAL REVENUES:								
Library Fund	13,923.35	135.00	-0-	-0-	-0-	22.91	-0-	14,035.44
Revenue Sharing, General	32,932.06	264.87	-0-	-0-	-0-	134.88	-0-	33,062.05
Revenue Sharing, Pct. I	9,679.72	-0-	-0-	-0-	-0-	-0-	-0-	9,679.72
Revenue Sharing, Pct. II	8,837.17	-0-	-0-	-0-	-0-	-0-	4,850.00	3,987.17
Revenue Sharing, Pct. III	10,959.79	-0-	-0-	-0-	-0-	-0-	-0-	10,959.79
Revenue Sharing, Pct. IV	33,535.93	-0-	-0-	-0-	-0-	-0-	-0-	33,535.93
Revenue Sharing, Solid Waste	11,332.06	-0-	-0-	-0-	2,659.13	-0-	-0-	8,672.93
CAPITAL PROJECTS FUNDS:								
Capital Improvements Fund.....	164,748.80	-0-	-0-	-0-	-0-	2,435.80	-0-	162,313.00
County Wide Right-of-Way	15,776.51	37.72	-0-	-0-	-0-	-0-	-0-	15,814.23
TRUST & AGENCY FUNDS:								
County Atty. Check Process. Fund ...	18.63	405.00	-0-	-0-	338.50	-0-	-0-	85.13
Dist. Atty. Check Process. Fund ...	970.04	-0-	-0-	-0-	-0-	100.92	-0-	869.12
State Cost	6,336.10	3,013.00	-0-	-0-	-0-	-0-	-0-	9,349.10
State CVC	166.50	560.00	-0-	-0-	-0-	-0-	-0-	726.50
Auto Registration	24,095.07	26,317.98	-0-	19,590.21	-0-	4,504.86	-0-	26,317.98
Adult Probation Fund	39,097.62	4,835.00	119.00	-0-	5,556.78	665.96	-0-	37,828.88
Juvenile Probation Fund	6,397.48	3,800.16	-0-	-0-	2,364.10	60.13	-0-	7,773.41
Tyler County TCDP.....	-0-	-0-	100.00	-0-	-0-	-0-	-0-	100.00
TOTAL ALL FUNDS:	\$829,934.12	\$914,767.33	\$323,244.97	\$323,244.97	\$124,669.31	\$ 61,096.89	\$ 4,850.00	\$1,554,085.25

General Fund is \$608.50 off with Treasurer. Voucher 25443 issued 3-1-84 for Retirement partially paid by Treasurer in February.

I hereby certify that this report is correct to the best of my knowledge and belief, according to records of my office.

Ann Nichol
Ann Nichol, Tyler County Auditor



February 24, 1984

Honorable Judge Allen Sturrock
County Judge, Tyler County
Woodville, Texas 75979

VOL 009 PAGE 37

Dear Judge Sturrock:

We have received a request from Commissioner Kenneth Lowe of Precinct 2 for permission to remove iron ore gravel from Kirby property in the G.W. Roper Survey, Abstract 757, Tyler County, at the location pointed out to our representative approximately as shown on the attached sketch in red.

We hereby grant such permission subject to the following understanding:

1. The material removed hereunder will be used in maintenance of county roads within Precinct 2.
2. Removal will be confined to an area of approximately 0.2 acres and total quantities removed will not exceed 600 cu. yds.
3. Timber within the pit site will be disposed of by Kirby Forest Industries, Inc.
4. Topsoil on the pit site will be stockpiled, and upon completion of removal, the pit will be scarified and the topsoil spread over the pit area and the site left in condition that it will drain freely and will not hold water.
5. Removal will be completed on or prior to December 31, 1984, at which time we would appreciate receiving from you a statement as to quantities actually removed.
6. The material being donated in this instance has an approximate value of \$2100.00.
7. In planning, maintaining, operating or abandoning the pit, we will look to you to comply with all applicable provisions of law and governmental regulations.

You may enter and commence removals subject to the above conditions and your agreement to submit this letter to the next regular session of the Commissioners Court for its official acceptance and approval. If this correctly sets forth our understanding, please execute the duplicate copy of this letter and return to me.

Yours very truly,

Marvin Davenport
Manager - Lands & Forests

Accepted and Approved this 12th day of March 1984.

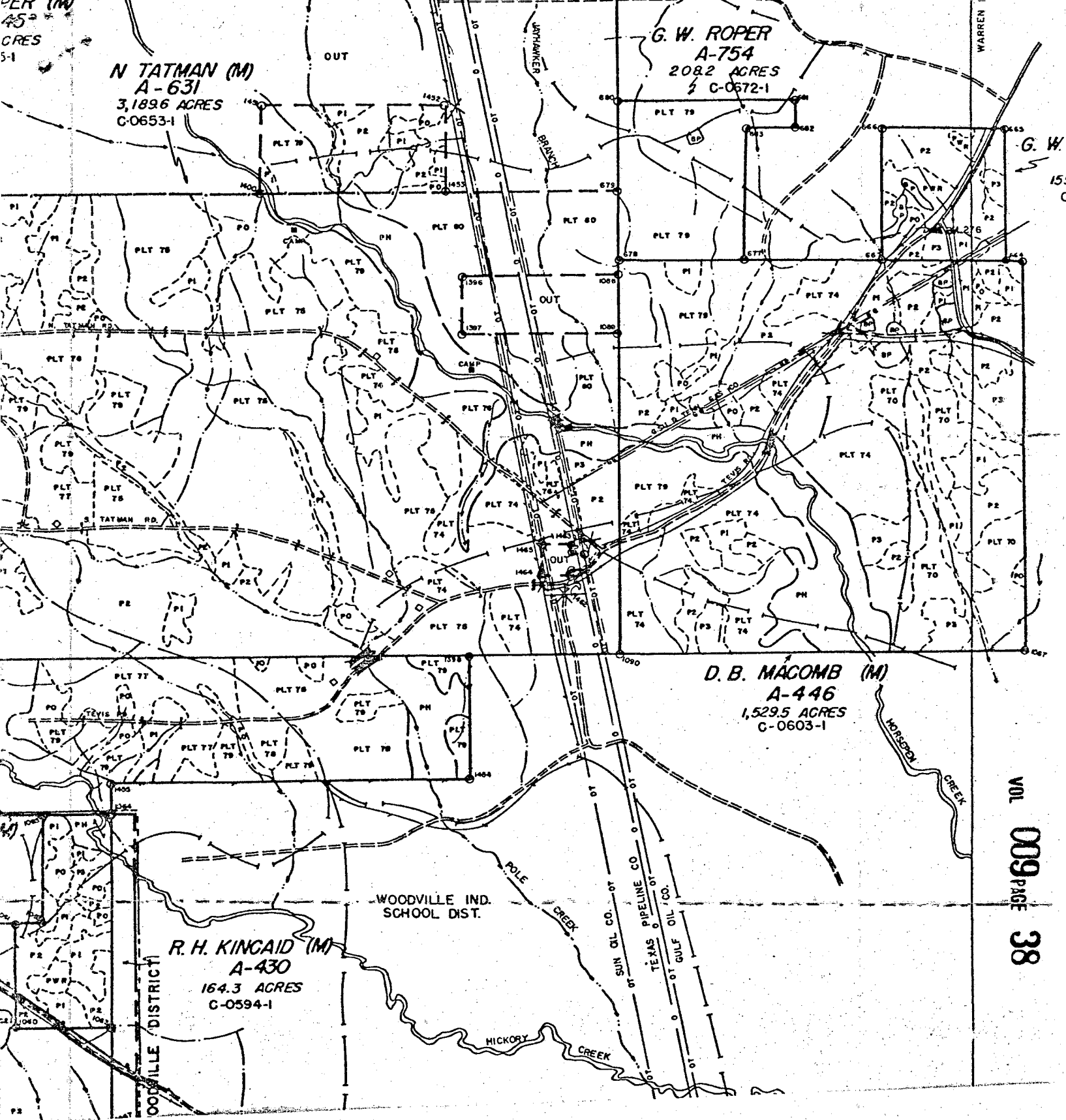

Attached to Letter Agreement dated February 24, 1984, between Kirby Forest Industries, Inc. and the County of Tyler, Texas, depicting the approximate location of proposed pit on Kirby's holdings as shown below.